

FOR LEASE



INDUSTRIAL BUILDINGS FOR LEASE



10 KVAs

1,650 m²

Contact us:

👤 Pedro Mercado

☎ +52 (442) 464 0816

✉ pedromercadopena@gmail.com

🌐 tbq.mx

🌐 parqueindustrialpyme.com.mx

Developed by



1,650 m²



BUILDING INFORMATION

LAND AREA

1,834.30 m²
19,744.24 ft²

CLEAR HEIGHT

9 m

FLOOR THICKNESS

15 cm concrete
MR 35

RAMPS

1

BUILDING AREA

1,650 m²
17,760.45 ft²

DOCKS

1

WALL MATERIAL

Block wall and KR 18
sheet metal wall

KVAs ENERGY POWER

10

SKYLIGHTS

10% Natural
lighting

PARKING LOT

4

ROOF MATERIAL

KR 18 sheet whit 3"

BUILDING LAYOUT

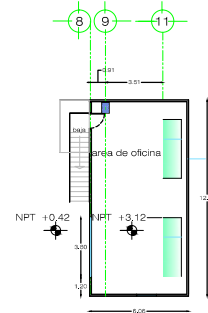

PLANTA ALTA PARA OFICINAS

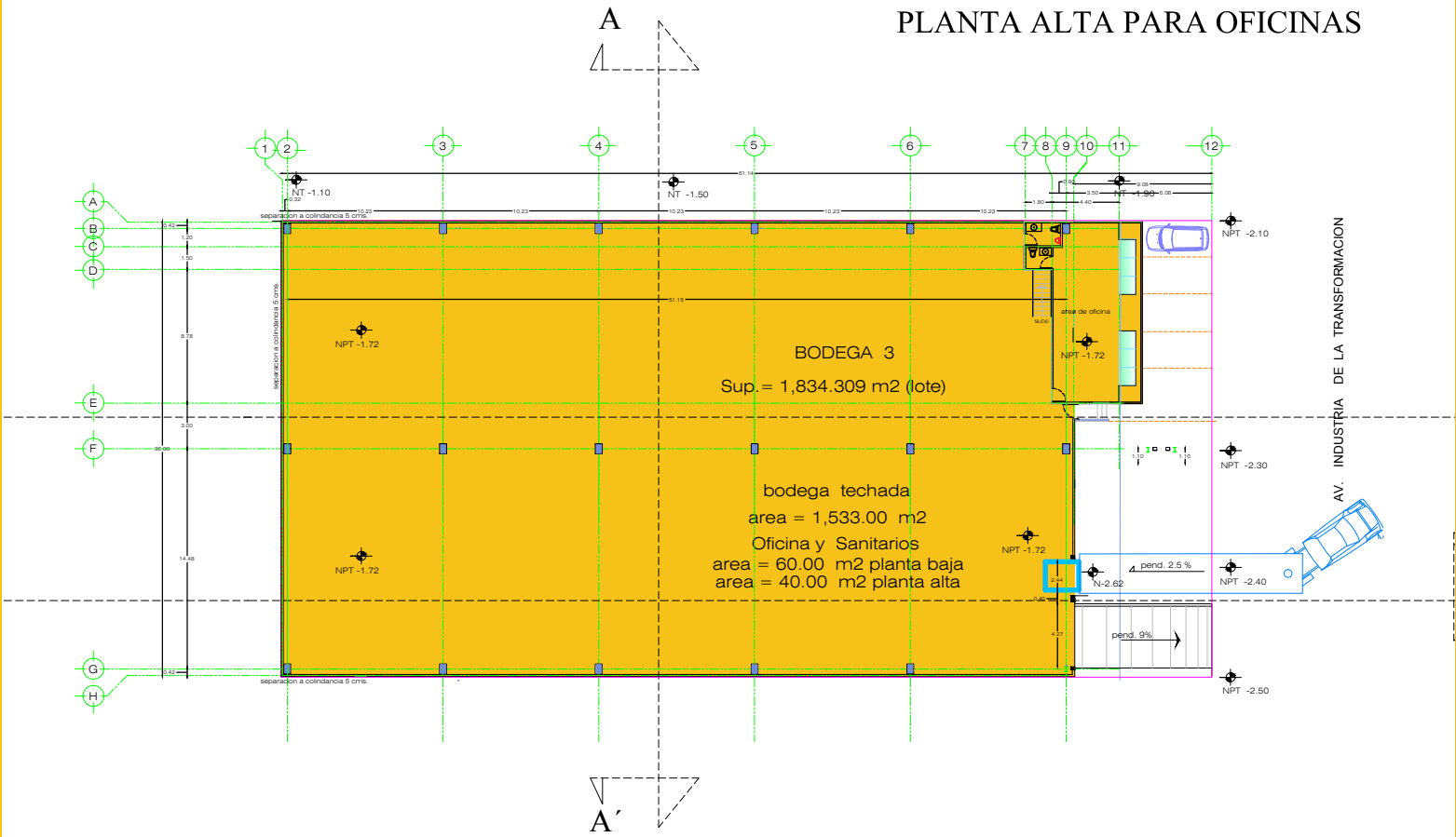

planta arquitectónica

ADVANTAGES

Parque Industrial Pyme



Electrical substation

More than 200,000
KVAS in Phase 1



Natural gas

Engie's main pipeline



Immediate property title transfer



Labor force

Communities around
pyme industrial park



PYME Settlers Association

- Surveillance 24/7.
- 38 CCTV Cameras.
- Green area maintenance.
- Streets signage, painting and maintenance.



PARK INFRASTRUCTURE



Electrical substation



Fire fighting equipment



Natural gas



Carriers



Security



Convenience stores



Water wells



Water treatment plant



Restaurant



Medical attention



**Settlement Association
Parque industrial PyME**



**Click to go
to the virtual tour**

MASTER PLAN



LOCATION

[Click to go to the Google Maps location](#)

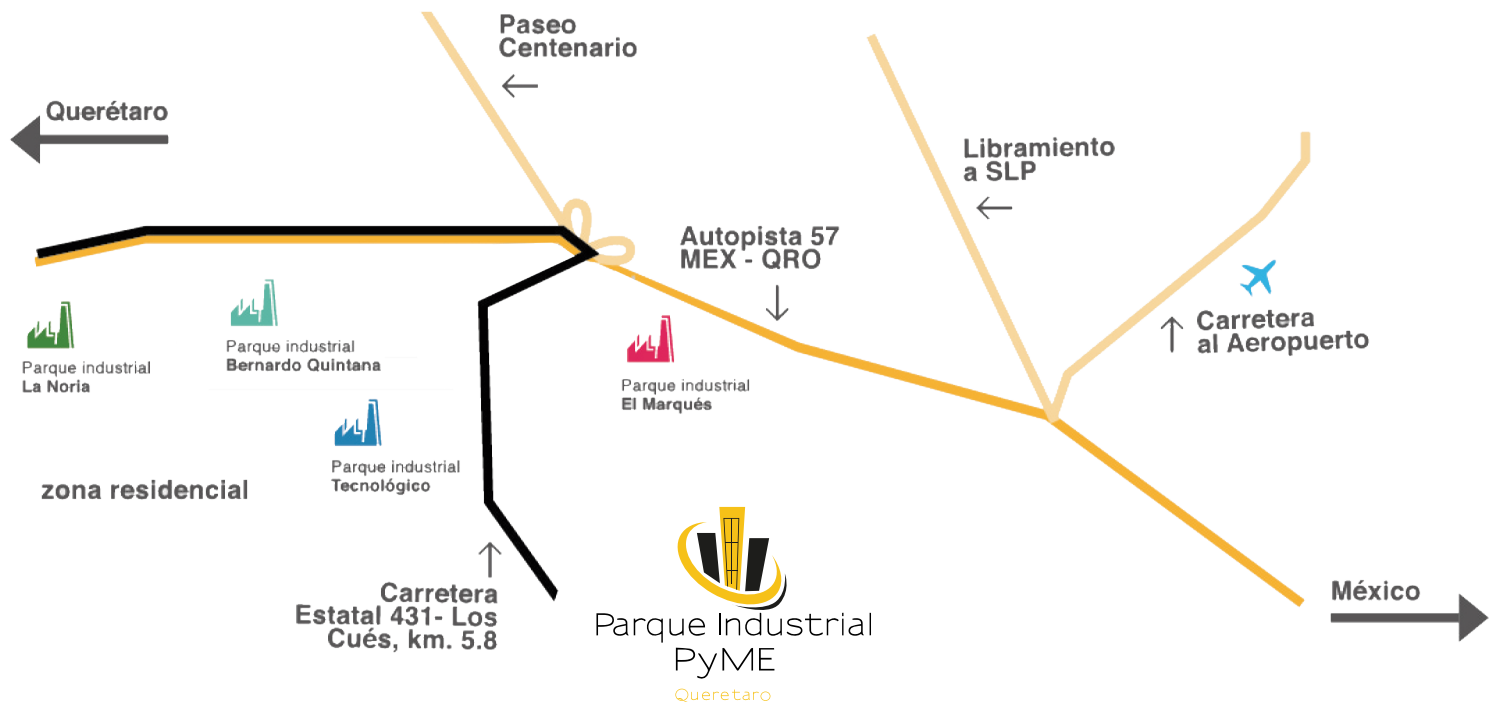





PYME

PARQUE INDUSTRIAL

Contact us:

 Pedro Mercado

 +52 (442) 464 0816

 pedromercadopena@gmail.com

 tbq.mx

 parqueindustrialpyme.com.mx

Developed by

